

CSULB –ECONOMICS

Classroom Emergency Procedures

Emergency Contact Information

- University Police **(562) 985-4101** – full service police agency, operating on campus 24 hours a day, 365 days a year.
- **911** from campus phone will connect to University Police.
- **911** from standard phone (cell) will connect to general dispatch.
- <http://emergency.csulb.edu>

Emergency Notification System

- In the case of a campus emergency, the University can send updates and critical information to you via text, voicemail and e-mail. It's therefore critical that your contact information is current.
- Visit the "Student Center" at MyCSULB to update your information.

Evacuation Procedures

- Take personal belongings.
- DO NOT use elevators, use nearest stairs & exit.
- Follow directions given by building marshal or campus official.
- Assist persons with access & functional needs.
- Go to designated evacuation point and do not return until directed to do so.
- Every person **MUST** evacuate the building.
- See Evacuation Map.

Evacuation Map

- Once you have evacuated safely, DO NOT leave the area until you have been released by the Building Marshal or campus official. It is critical for emergency response that we have an accurate count of all individuals, to ascertain who may have remained in the facility.

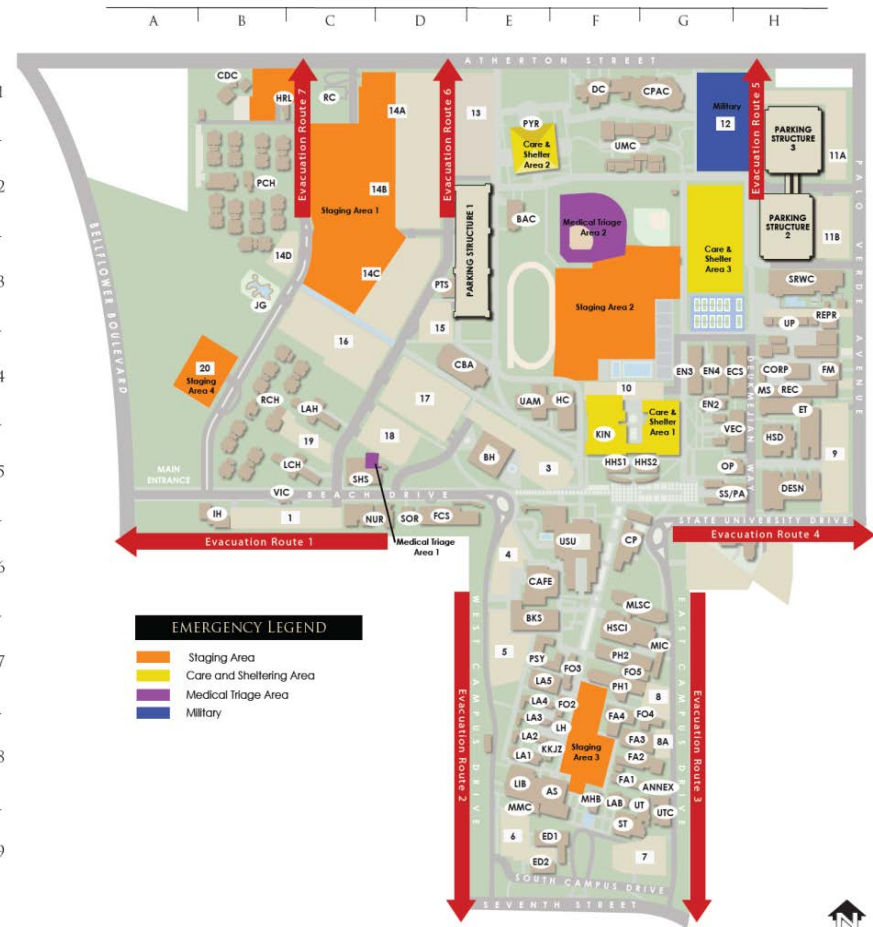

Fire



- Activate nearest fire alarm and call **911**.
- Evacuate the building & notify occupants as you leave.
- Do not return until authorized by emergency personnel.
- Do not use elevators.
- Fire Extinguisher instructions if trained:
 - P** - Pull safety Pin from handle.
 - A** - Aim nozzle at base of fire.
 - S** - Squeeze the trigger handle.
 - S** - Sweep from side to side (watch for re-flash).

Earthquake

- **DROP-COVER-HOLD** under a table or desk or against an interior wall until shaking stops. Protect head and neck. Do not stand in a doorway and do not run out of the building while it is shaking.
- After shaking stops, check yourself and others for injuries.
- Do not use the elevators. Move towards the nearest exit and evacuate to a safe location away from buildings, trees, streetlights and overhangs.
- Follow directions given by building marshals or campus officials and be prepared for aftershocks.

Bomb Threat

- Report all threatening calls to police at:
562-985-4101.
- Ask caller:
 - ✓ When is the bomb going to explode?
 - ✓ Where is the bomb?
 - ✓ What kind of bomb is it?
 - ✓ What does it look like?
 - ✓ Why did you place the bomb?
- Be attentive to caller for recall when questioned by the police.

If suspicious object is found:

DO NOT HANDLE – DIAL 911.

Active Shooter

- **RUN:** Leave your belongings behind. If there is an escape path, attempt to evacuate. Help others if possible.
- **HIDE:** If you cannot get out safely, hide. Lock or barricade the door, silence your cell phone and stay quiet. Be aware of your surroundings and know options for escape.
- **FIGHT:** As a last resort, and only if your life is in danger, you may need to attempt to incapacitate the shooter. Work in unison if others are with you. Act with physical aggression and use improvised weapons if able.

Shelter in Place

- Stay in building; close and lock windows and doors.
- Move into an interior room away from windows.
- Do not use the elevators.
- Remain in shelter until emergency personnel announce that it is safe.

Hazardous Waste

- If contaminated, remove clothing and rinse with water for 15 minutes.
- If an immediate hazard or emergency exists, call **911**.
- Move away or evacuate if there is a health risk. Notify others and close doors as you leave.
- For small spills, those not involving immediate danger, confine and contain spill if trained and call University Police at **562-958-4101**.

Medical Procedures

- Call 911
- Be ready to describe the nature and severity of medical problem and provide estimated age/gender.
- Keep victim still and comfortable.
- Render first aid/CPR if trained.
- Look for emergency medical ID.